

Free Standing Sign Holder

Scan to view Product Instructional Video or visit:
www.creativeDisplaysite.com/3ftFreeStanding.html



Product Parts

- 1 - Feet (x2)
- 2 - Wing Nut
(x2 for 24" Wide)
(x3 for 36" Wide)
- 3 - Bolt (x3)
(x2 for 24" Wide)
(x3 for 36" Wide)

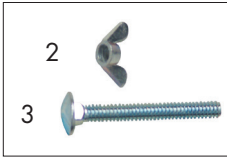

*Spare parts are not listed
*Drill required for assembly - (not included)



Sign Install and Display Set-Up

Step 1

Align the inside of one of the Feet (1) to the bottom of your graphic.



Mark holes on graphic and then drill the holes.



Step 2

Stand both Feet (1) up so they are on their side with the holes on both feet facing each other.

Place the graphic between both Feet (1) so all the drill holes are aligned.



Step 3

Thread a Bolt (3) through the holes in the graphic and Feet (1) then tighten with Wing Nut (2).

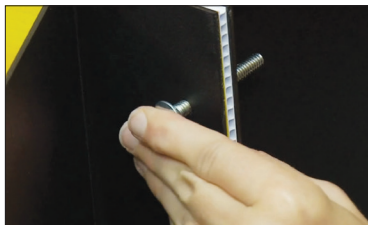

Repeat on the other side.



Step 4

Set your display upright.



Storage & Care

Store in a cool dry location. To clean, wipe with damp cloth.

Warranty Information: All products are designed to provide the user with a cost-effective and durable product. Standard warranty is a 'one year parts and labor' warranty which warrants product against defects in material and workmanship. It does not cover damage due to accidents, abuse, or normal wear and tear. Products found to be defective will be replaced or repaired at factory's discretion.